

Butler's

thoughtful estate agency



Morland Road
Sutton, SM1 4RP
Guide price £550,000



Morland Road

Sutton, SM1 4RP

Located in one of central Sutton's most convenient roads, this three-bedroom period home is not to be missed. This home has been well cared for by the current owners and has been extended and updated throughout their occupation. It offers ample space and is ideal for a growing family.

The location is highly convenient. Set within a quiet, non-cut-through road, yet in a very desirable area, you have access to excellent schools, transport links, and amenities nearby.

The property is offered in good order, with a comfortable lounge space. The main living area of the home is the kitchen, which offers a generous amount of workspace. The adjacent dining room is semi-open plan, making it suitable for family meals and entertaining.

Upstairs on the first floor, the bedrooms are well proportioned, with sufficient space for wardrobes in each room. This floor is served by a practical family bathroom, updated in keeping with the period of the property.

On the second floor, the loft conversion provides light and spacious double bedroom with en-suite, which can be used as a private retreat and is ideally suited as the main bedroom.

Finally, outside, there is a well-sized garden suitable for all ages and a variety of uses, with a useful covered side area.

GROUND FLOOR

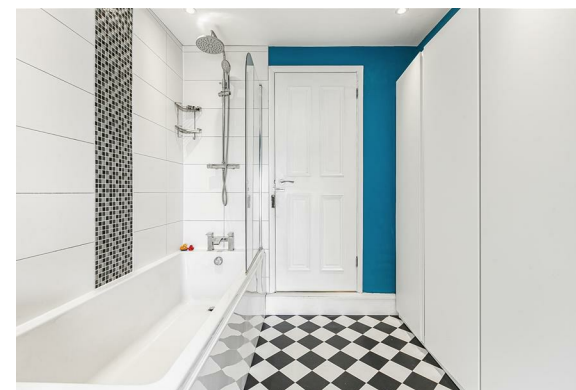



Hallway

Living Room
11'6 x 10'6 (3.51m x 3.20m)

Dining Room
14'6 x 13'11 (4.42m x 4.24m)

Kitchen
10'6 x 8'6 (3.20m x 2.59m)

FIRST FLOOR

Landing

Bedroom
14' x 11'9 (4.27m x 3.58m)

Bedroom
14'8 x 7'7 (4.47m x 2.31m)

Bathroom
10'6 x 8'3 (3.20m x 2.51m)



SECOND FLOOR

Landing

Bedroom
18' x 13'9 maximum (5.49m x 4.19m maximum)

En-Suite
7'10 x 5' (2.39m x 1.52m)

OUTSIDE

Covered Side Area

Rear Garden



Floor Plan

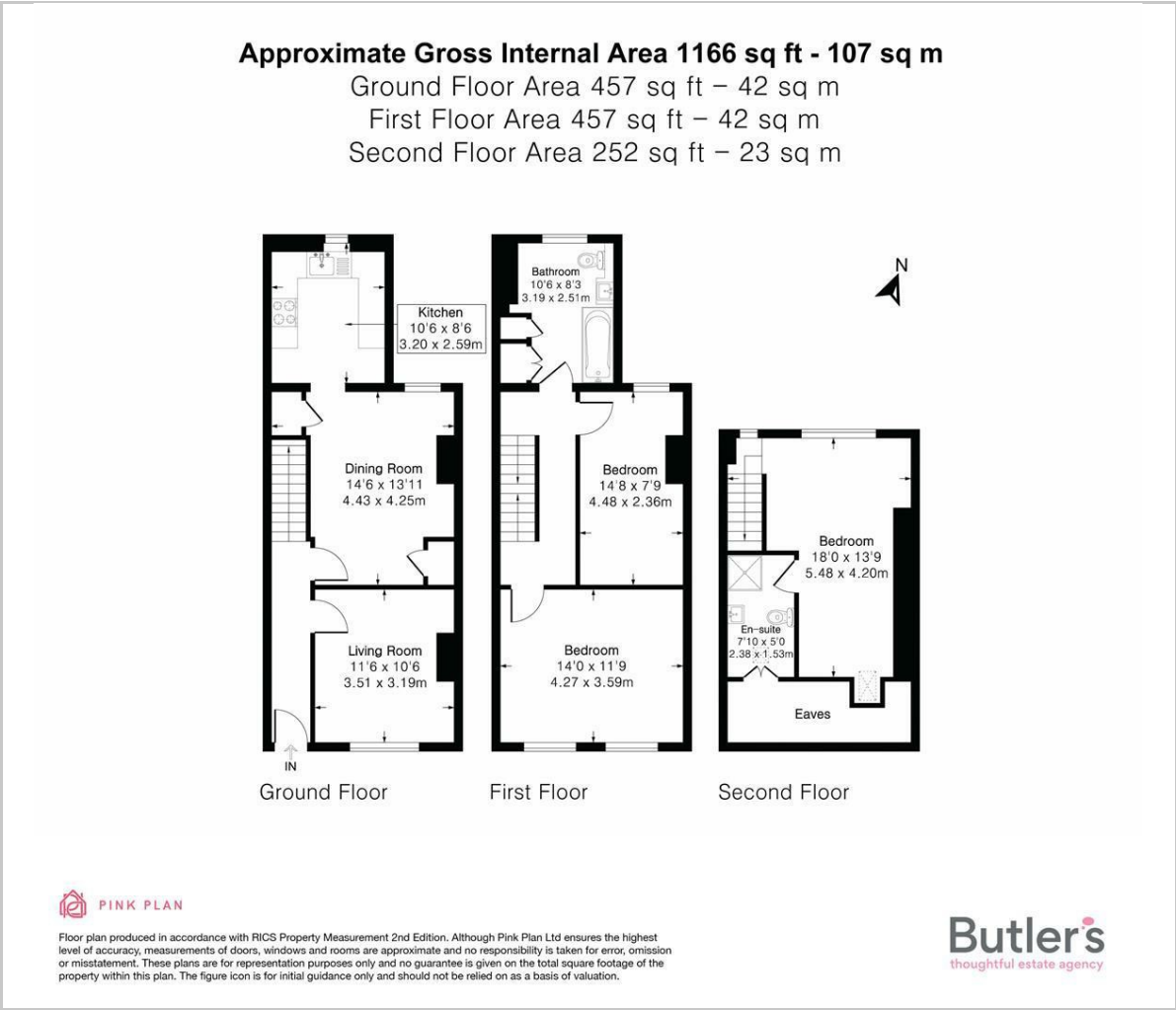

Viewing

Please contact our Butler's Sales Office on 020 39 170 160 if you wish to arrange a viewing appointment for this property or require further information.

These particulars, whilst believed to be accurate are set out as a general outline only for guidance and do not constitute any part of an offer or contract. Intending purchasers should not rely on them as statements of representation of fact, but must satisfy themselves by inspection or otherwise as to their accuracy. No person in this firms employment has the authority to make or give any representation or warranty in respect of the property.

18 Sutton Plaza, Sutton, Surrey, SM1 4FS
Tel: 020 39 170 160 Email: sutton@butlershomes.co.uk butlershomes.co.uk

Area Map

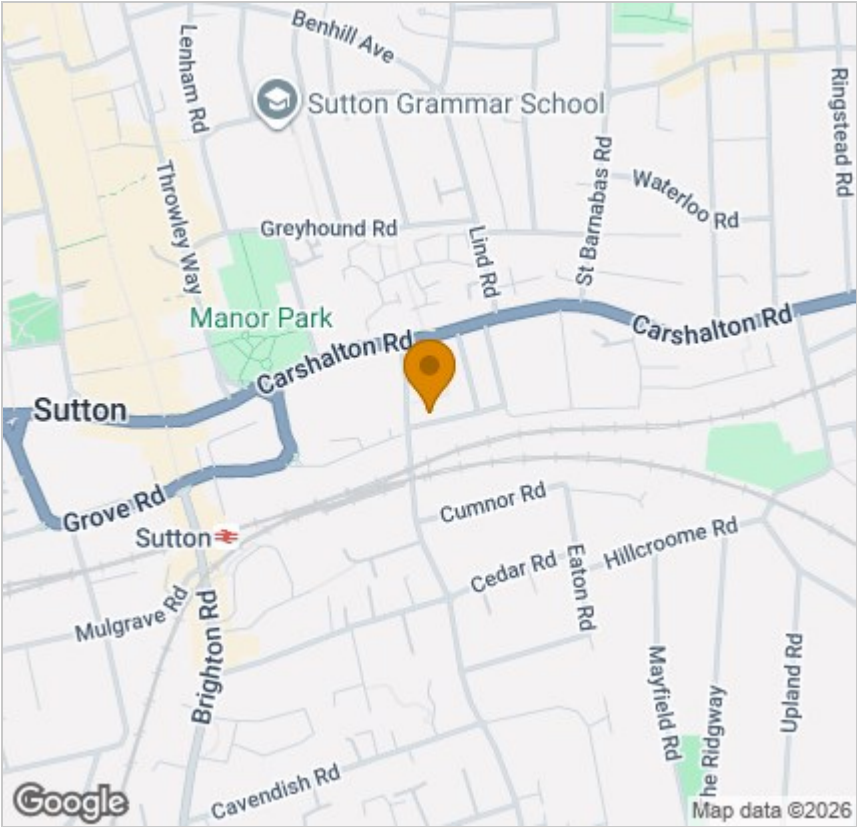

Energy Efficiency Graph

